



This Crown Record Register Search is a true and correct extract of the Register of Crown Records maintained by the Registrar-General. Crown Land is administered pursuant to the Crown Land Management Act 2009 by the Department of Environment, Water and Natural Resources.

Crown Record - Volume 5257 Folio 150

Parent Title(s)	CL 1607/10			
Creating Dealing(s)	S 7850829			
Title Issued	24/03/1995	Edition 2	Edition Issued	19/06/1995

Estate Type

CROWN LAND (ALIENATED)

Owner

THE CROWN

Custodian

THE DISTRICT COUNCIL OF ELLISTON
OF PO BOX 46 ELLISTON SA 5670

Description of Land

SECTION 221
HUNDRED OF COLTON
IN THE AREA NAMED BRAMFIELD

TOTAL AREA: 2.023HA (CALCULATED)

DIAGRAM BOOK PAGE 6

Easements

NIL

Schedule of Dealings

NIL

Schedule of Interests

LAND DEDICATED FOR COMMUNITY PURPOSES PURSUANT TO THE CROWN LANDS ACT, 1929 BY GAZETTE
08/06/1995

Notations

Dealings Affecting Title	NIL
Priority Notices	NIL
Registrar-General's Notes	NIL
Administrative Interests	NIL

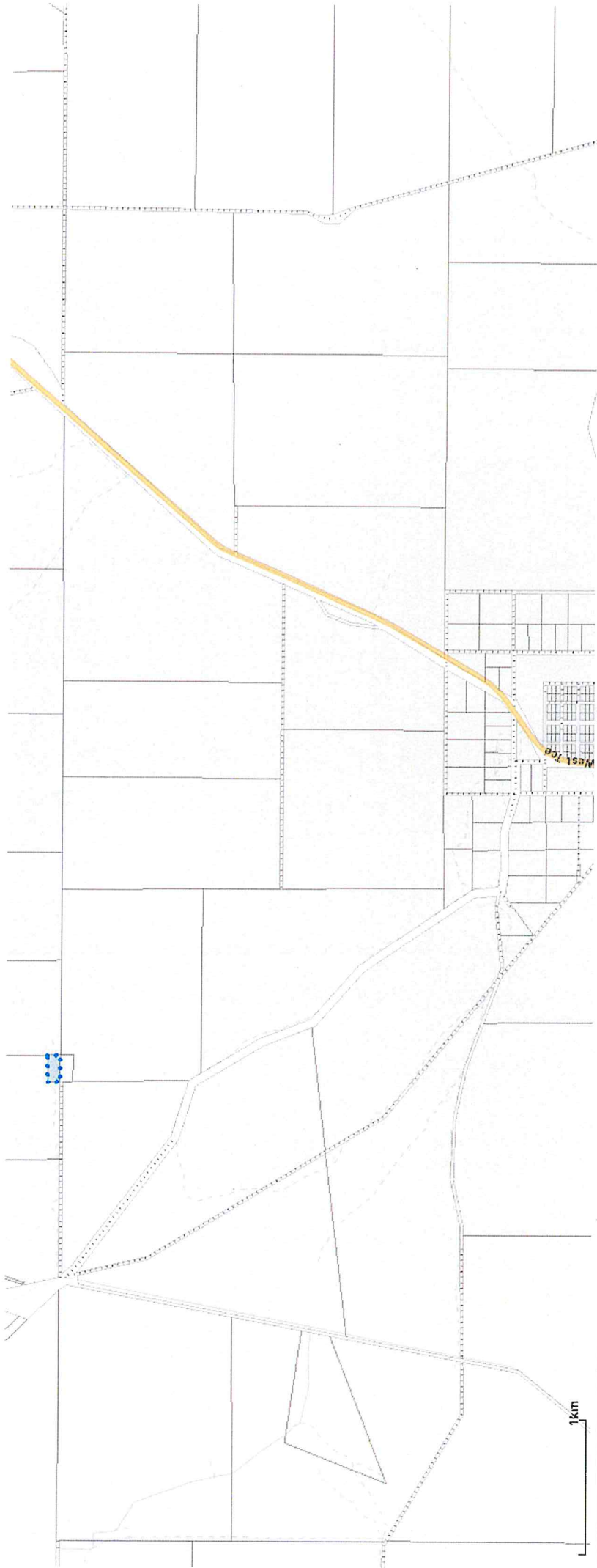

[* Remove](#)
[& Zoom to](#)
[Print](#)
 Export table to:
 [CSV](#)
[PDF](#)
[HTML](#)
[Excel](#)
[SALUS Link](#)

[Property Data](#)
[Zoning - Development Act](#)
[Zoning - PDI Act](#)

Plan	>	Property Unit	>	Property St No.	>	Property St Name	>	Property St Type	>	Property Suburb	>	Valuation No.
Par... H5503005E...		CR5257/150		LOT221		GROVE		RD		BRAMFIELD		9370575005